

SAMPLE PROJECT 3

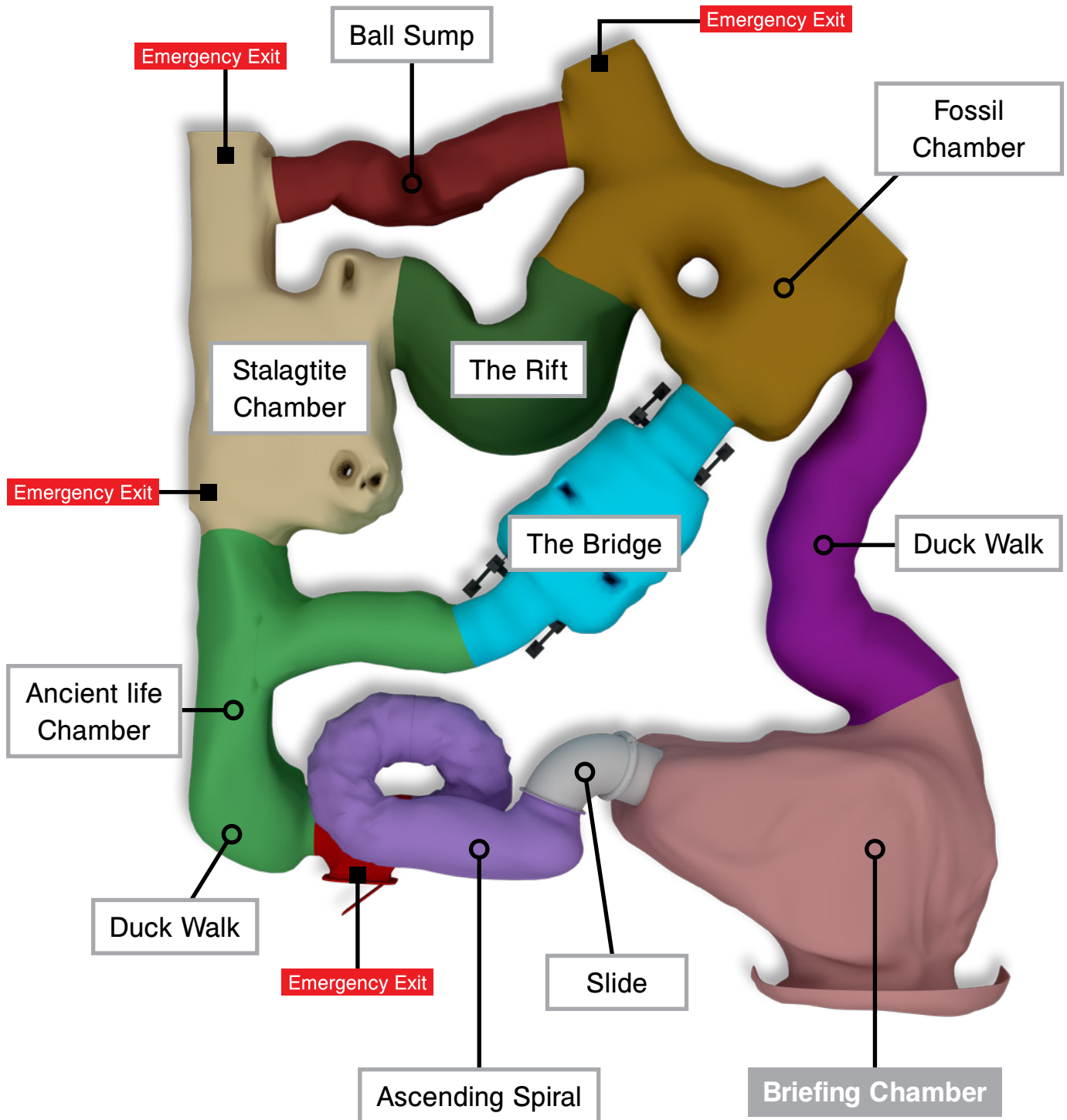

Components

- Ventilation system
- LED lighting
- CCTV
- Sound system
- Emergency exits
- Gear (helmets, knee pads, torches)
- Ball sump
- Rubber floor
- Bridge

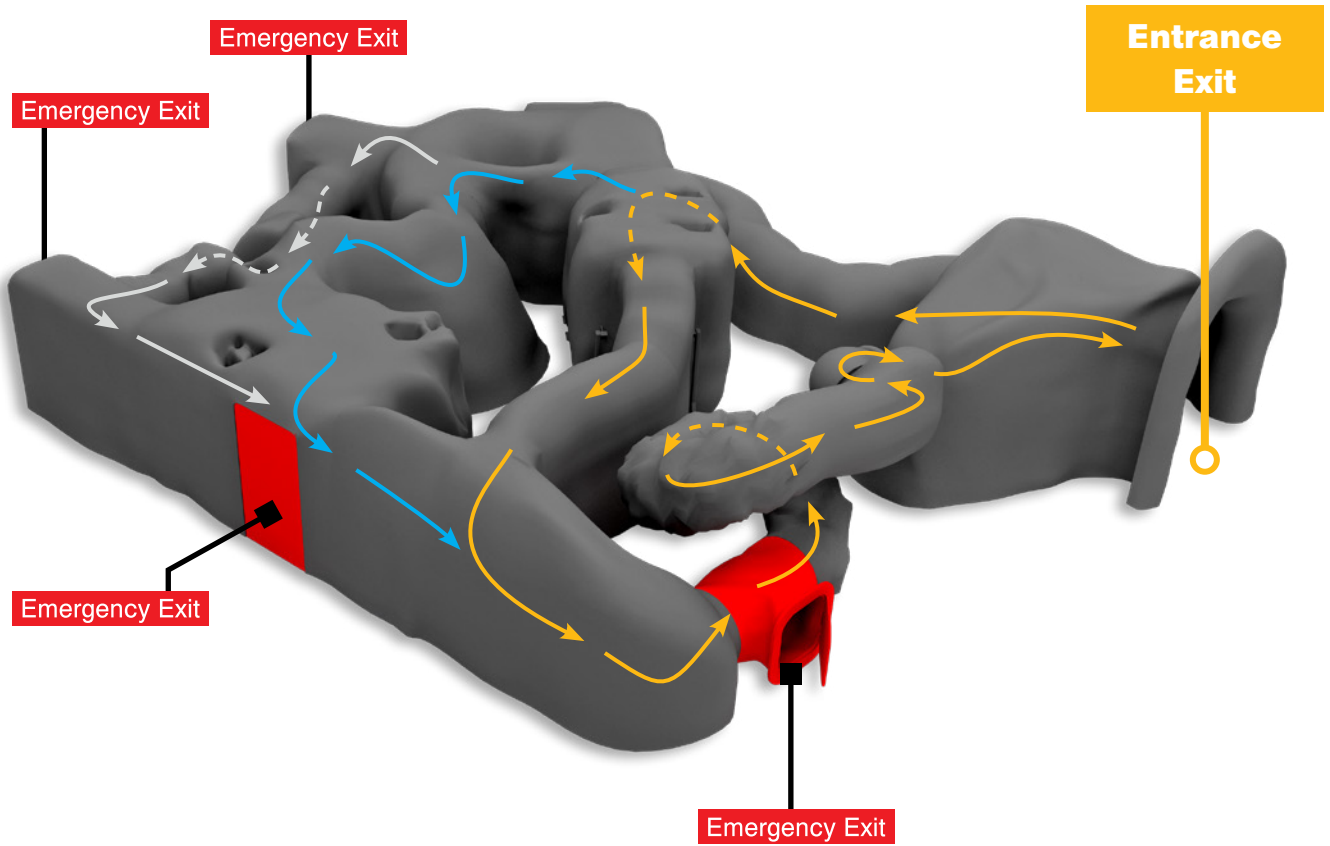

Momentum Capacity	21 people	
Footprint	136 m ²	1,463.8 ft ²
Height	3,5 m	11.4 ft
Operational Length	57 m	187 ft
Routes	2	
Min. Operators Required	2	
GRP	337m ²	3,627.4 ft ²